

MCR & MCR-S
MCRV & MCRV-S
 Single Row
 Stud Type

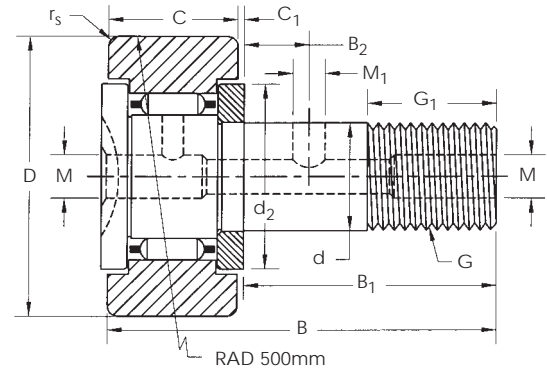

- MCR Caged Unsealed
- MCR-S Caged Sealed
- MCRV Full Complement Unsealed
- MCRV-S Full Complement Sealed

SMITH Bearing® Number	Dimensions (mm) <i>(For Tolerances, See chart in Engineering Section)</i>													Basic Load Ratings				Max Speed* (rpm)	Mass (grams)
	D	d	C**	r _s	B	B ₁	B ₂	G	G ₁	M	M ₁	C ₁	d ₂	dyn Newtons	stat Newtons	dyn Newtons	stat Newtons		
														C	C ₀	C _w	C _{ow}	n	g
MCR-16	16	6	11	0.15	28	16	-	M6 x 1	8	4†	-	0.6	12	3800	3750	3150	3300	22000	20
MCR-16-S														16000					
MCRV-16														6400	8500	4850	6500	8500	22
MCRV-16-S														8500					
MCR-19	19	8	11	0.15	32	20	-	M8 x 1.25	10	4†	-	0.6	14	4250	4600	3500	3900	20000	31.2
MCR-19-S														14000					
MCRV-19														7300	10800	5500	7900	7000	35.2
MCRV-19-S														7000					
MCR-22	22	10	12	0.30	36	23	-	M10 x 1	12	4	-	0.6	17	5700	6500	4450	5200	16000	48.3
MCR-22-S														11000					
MCRV-22														8600	12900	6300	9100	6000	49.3
MCRV-22-S														6000					
MCR-26	26	10	12	0.30	36	23	-	M10 x 1	12	4	-	0.6	17	5700	6500	5100	6200	16000	62.3
MCR-26-S														11000					
MCRV-26														8600	12900	7300	11300	6000	65.3
MCRV-26-S														6000					
MCR-30	30	12	14	0.60	40	25	6	M12 x 1.5	13	6	3	0.6	23	8100	9700	6800	8400	11000	92.5
MCR-30-S														8300					
MCRV-30														12200	19000	9500	14600	4500	94.5
MCRV-30-S														4500					
MCR-32	32	12	14	0.60	40	25	6	M12 x 1.5	13	6	3	0.6	23	8100	9700	7100	9000	11000	103.5
MCR-32-S														8300					
MCRV-32														12200	19000	10000	15800	4500	105.5
MCRV-32-S														4500					
MCR-35	35	16	18	0.60	52	32.5	8	M16 x 1.5	17	6	3	0.8	27	12900	19000	9700	14100	7000	181.5
MCR-35-S														7000					
MCRV-35														18300	35000	12800	23000	3400	183.5
MCRV-35-S														3400					
MCR-40	40	18	20	1.00	58	36.5	8	M18 x 1.5	19	6	3	0.8	32	14200	20400	10900	15500	6000	262.8
MCR-40-S														6000					
MCRV-40														21000	39500	14800	26500	2900	264.8
MCRV-40-S														2900					

† Relubricate through head end only.

** Tolerance for "C" Raceway Width is +0.00/-0.12 mm

For Dimensional Tolerances, see Metric Tolerance Chart in Engineering Section.

MCR & MCR-S
MCRV & MCRV-S

Single Row

Stud Type

(continued)

(chart continued from preceding page)

SMITH Bearing® Number	Dimensions (mm) <i>(For Tolerances, See chart in Engineering Section)</i>														Basic Load Ratings				Max Speed* (rpm)	Mass (grams)
	D	d	c**	r _s	B	B ₁	B ₂	G	G ₁	M	M ₁	C ₁	d ₂	dyn Newtons	stat Newtons	dyn Newtons	stat Newtons			
														C	C ₀	C _w	C _{ow}	n	g	
MCR-47	47	20	24	1.0	66	40.5	9	M20x1.5	21	8	4	0.8	37	19500	32000	15500	25500	4900	405.5	
MCR-47-S																	4900			
MCRV-47														28000	59000	20600	42000	2600	409.5	
MCRV-47-S																	2600			
MCR-52	52	20	24	1.0	66	40.5	9	M20x1.5	21	8	4	0.8	37	19500	32000	16800	28500	4900	480.5	
MCR-52-S																	4900			
MCRV-52														28000	59000	22500	48000	2600	484.5	
MCRV-52-S																	2600			
MCR-62	62	24	29	1.0	80	49.5	11	M24x1.5	25	8	4	0.8	44	30500	53000	26500	47500	3800	818.2	
MCR-62-S																	3800			
MCRV-62														41500	91000	34000	76000	2200	830.2	
MCRV-62-S																	2200			
MCR-72	72	24	29	1.1	80	49.5	11	M24x1.5	25	8	4	0.8	44	30500	53000	28000	53000	3800	1068.2	
MCR-72-S																	3800			
MCRV-72														41500	91000	37000	85000	2200	1073.2	
MCRV-72-S																	2200			
MCR-80	80	30	35	1.1	100	63.0	15	M30x1.5	32	8	4	1.0	53	45000	85000	39500	77000	2600	1610.0	
MCR-80-S																	2600			
MCRV-80														60000	142000	49500	120000	1700	1621.0	
MCRV-80-S																	1700			
MCR-85	85	30	35	1.1	100	63.0	15	M30x1.5	32	8	4	1.0	53	45000	85000	40500	80000	2600	1800.0	
MCR-85-S																	2600			
MCRV-85														60000	142000	44000	120000	1700	1820.0	
MCRV-85-S																	1700			
MCR-90	90	30	35	1.1	100	63.0	15	M30x1.5	32	8	4	1.0	53	45000	85000	41500	83000	2600	2010.0	
MCR-90-S																	2600			
MCRV-90														60000	142000	53000	130000	1700	2030.0	
MCRV-90-S																	1700			

- 1) Standard bearing has Crowned Roller Outside Diameter – For Straight Cylindrical Outside Roller Diameter, add suffix "C." Example: **MCR-16-C**
 - 2) Add suffix "B" for hex-drive socket. Example: **MCR-16-B**
 - 3) Add suffix "E" for eccentric collar. Example: **MCR-16-E**
 - 4) The basic load rating C and C₀ apply if the bearing outer ring (with cylindrical outside surface) is mounted in a housing bore with the normal rolling bearing fit. When used as a track roller, the load rating C_w and C_{ow} apply.
 - 5) *Limiting Speed for grease lubrication: For oil lubrication speed may be increased by up to 30%.
 - 6) ** Tolerance for "C" Raceway Width is +0.00/-0.12 mm
- † Relubricate through head end only.

For Dimensional Tolerances, see Metric Tolerance Chart in Engineering Section.

