

YR-C & YR-XC

Crowned • Yoke Type

Crowned Outer Race
for Shaft Mounting
Sealed or Unsealed
X = Sealed

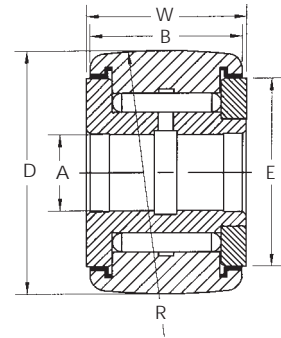

Dimensional Data (inches)

SMITH Bearing® Number		D Roller O.D. +.000 -.001	A Bore Nominal	Tolerance	B Roller Width +.000 -.005	W Overall Width +.005 -.010	E Min Clamping Dia.	Recommended Shaft Dia.				Basic Dynamic Rating (lbs)	Max Static Capacity (lbs)	R Crown Radius (Inches)
UNSEALED	SEALED							Slip Fit		Press Fit				
								Max.	Min.	Max.	Min.			
YR-3/4-C	YR-3/4-XC	.750	.2500	+0.002 -0.004	.500	.5625	1/2	.2497	.2493	.2505	.2501	2140	4170	10
YR-7/8-C	YR-7/8-XC	.875												
YR-1-C	YR-1-XC	1.000	.3125		.625	.6875	5/8	.3122	.3118	.3130	.3126	3030	6200	12
YR-1 1/8-C	YR-1 1/8-XC	1.125												
YR-1 1/4-C	YR-1 1/4-XC	1.250	.3750		.750	.8125	3/4	.3747	.3743	.3755	.3751	44700	8600	14
YR-1 3/8-C	YR-1 3/8-XC	1.375												
YR-1 1/2-C	YR-1 1/2-XC	1.500	.4375		.875	.9375	57/64	.4372	.4368	.4380	.4376	5560	11300	20
YR-1 5/8-C	YR-1 5/8-XC	1.625												
YR-1 3/4-C	YR-1 3/4-XC	1.750	.5000		1.000	1.0625	1 3/64	.4997	.4993	.5007	.5003	7870	15870	20
YR-1 7/8-C	YR-1 7/8-XC	1.875												
YR-2-C	YR-2-XC	2.000	.6250		1.250	1.3125	1 13/64	.6247	.6243	.6257	.6253	10370	22000	24
YR-2 1/4-C	YR-2 1/4-XC	2.250												
YR-2 1/2-C	YR-2 1/2-XC	2.500	.7500	1.500	1.5625	1 5/16	.7497	.7493	.7507	.7503	15280	33000	30	
YR-2 3/4-C	YR-2 3/4-XC	2.750												
YR-3-C	YR-3-XC	3.000	1.0000	1.750	1.8125	1 3/4	.9996	.9992	1.0008	1.0003	202000	49900	30	
YR-3 1/4-C	YR-3 1/4-XC	3.250												
YR-3 1/2-C	YR-3 1/2-XC	3.500	1.1250	2.000	2.0625	2	1.1246	1.1241	1.1258	1.1253	29660	63300	30	
YR-4-C	YR-4-XC	4.000												
	YR-5-XC	5.000	1.2500	2.250	2.3125	2 1/4	1.2496	1.2491	1.2508	1.2503	35980	90000	30	
	YR-6-XC	6.000												
	YR-5-XC	5.000	1.7500	2.750	2.8750	3	1.7496	1.7491	1.7508	1.7503	49750	136000	48	
	YR-6-XC	6.000	2.2500	3.250	3.3750	3 1/2	2.2496	2.2491	2.2508	2.2503	71400	162000	56	