

MVCR
V-Groove Stud Style

SMITH-TRAX®

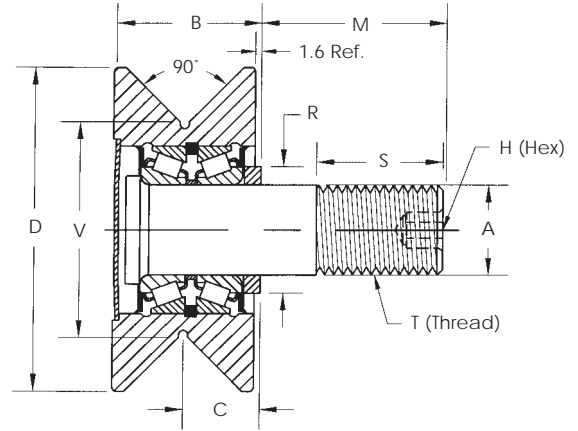

General Information

The **Smith-Trax®** Series bearings are designed and manufactured to handle increased axial and radial loads by using **Tapered Roller Bearings** or **Deep Groove Ball Bearings**. These bearings should be used when standard needle roller bearings are not sufficient to handle the thrust load found in certain applications. Consult our Engineering Department for special requirements.

Dimensional Data (mm)

SMITH Bearing® Number	BEARING TYPE	D Outside Roller O.D.	V Point Dia.	B Roller Width	C Groove Center	A Stud Dia. +0.00 -0.02	M Stud Length	S Eff. Thread Min.	T Thread	H Hex Size	R Shoulder or End Plate Dia.	Radial Basic Dynamic Rating (N) 500 hrs. 33 rpm.	Dynamic Thrust Load Rating (N) 500 hrs. 33 rpm.	Max Static Capacity (N)
	TRB-Tapered Roller Bearing BB-Ball Bearing													
MVCR-26	BB	40	26	20	10	10	23.0	13	M10 x 1	4	13.1	2,790	1,720	1,000
MVCR-32	BB	50	32	22	11	12	25.0	14	M12 x 1.5	8	15.9	6,000	3,700	2,680
MVCR-40	BB	60	40	33	17	17	40.0	26	M14 x 2	8	18	6,000	3,700	2,680
MVCR-62	TRB	90	62	44.5	23	24	58.0	35	M24 x 3	8	32	23,100	14,200	10,100
MVCR-76	TRB	120	76	50.5	26	30	69.5	40	M30 x 3.5	8	44.5	63,600	25,700	89,000
MVCR-100	TRB	140	100	50.5	26	30	80.0	50	M30 x 3.5	8	44.5	63,600	25,700	89,000
MVCR-125	TRB	165	125	76	37.8	48	105.0	50	M48 x 5	12	82.5	148,100	58,500	230,800