

VCR
V-Groove Stud Type

SMITH-TRAX®

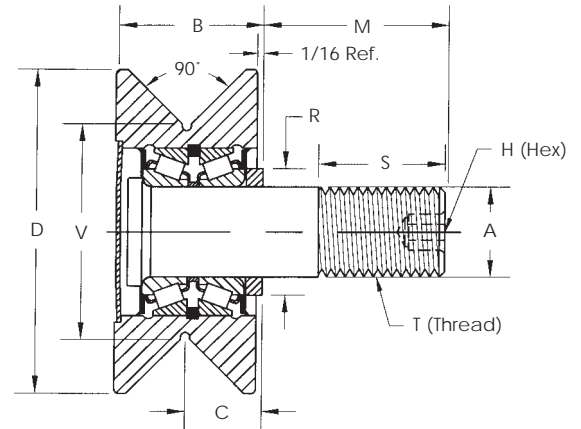

General Information

The **Smith-Trax®** Series bearings are designed and manufactured to handle increased axial and radial loads by using **Tapered Roller Bearings** or **Deep Groove Ball Bearings**. These bearings should be used when standard needle roller bearings are not sufficient to handle the thrust load found in certain applications. Consult our Engineering Department for special requirements.

Dimensional Data (inches)

SMITH Bearing® Number	BEARING TYPE	D Outside Roller O.D.	V Point Dia.	B Roller Width	C Groove Center	A Stud Dia. +.001 -0.000	M Stud Length	S Eff. Thread Min	T Thread U.N.F. Class 2A	H Hex Size	R Shoulder or End Plate Dia.	Radial Basic Dynamic Rating (lbs) 500 hrs. 33 rpm.	Dynamic Thrust Load Rating (lbs) 500 hrs. 33 rpm.	Max Static Capacity (lbs)
	TRB-Tapered Roller Bearing BB-Ball Bearing													
VCR-3½	BB	3.500	2.250	1 ¹¹ / ₁₆	7/8	0.875	2	1 ¹ / ₈	7/8-14	5/16	1	3,490	1,830	2,000
VCR-4½	TRB	4.500	3.000	2	1	1.250	2 ¹ / ₂	1 ³ / ₄	1 ¹ / ₄ -12	1/2	1 ³ / ₄	14,300	5,790	16,000
VCR-5½	TRB	5.500	4.000	2	1	1.250	2 ³ / ₄	1 ³ / ₄	1 ¹ / ₄ -12	1/2	1 ³ / ₄	15,300	5,790	16,000
VCR-6½	TRB	6.500	5.000	3	1 ¹ / ₂	2.000	4 ¹ / ₂	2 ¹ / ₂	2-12	5/8	3 ¹ / ₄	35,800	13,300	40,000
VCR-7½	TRB	7.500	6.000	3	1 ¹ / ₂	2.500	5 ¹ / ₂	3 ¹ / ₄	2 ¹ / ₂ -12	5/8	3 ¹ / ₄	35,800	14,200	62,000
VCR-8½	TRB	8.500	7.000	3	1 ¹ / ₂	2.500	5 ¹ / ₂	3 ¹ / ₄	2 ¹ / ₂ -12	5/8	3 ¹ / ₄	35,800	14,200	62,000